

REVISIONS

NO.	DATE	DESCRIPTION	BY	CKD
1	9/23/96	ADDED 1.375 DIA DIM	GB	
2	11/04/08	ADDED DIMENSIONS	BH	
3	3/12/21	CHANGED TO MPS BORDER	KMK	

NOTES:

- 1) ALL DIMENSIONS ARE REFERENCE AND ARE IN INCHES
- 2) ALL ITEMS HOT DIP GALVANIZED (ASTM A-153) EXCEPT ITEM ⑤
- 3) ALL ITEMS SHOULD BE PACKED COMPLETELY ASSEMBLED, IN PACKS OF 25, IN DOUBLE WALL CARDBOARD BOXES (APPROXIMATELY 6" x 6" x TOTAL LENGTH"). BOXES SHOULD HAVE MPS LOGO OR BE PLAIN.

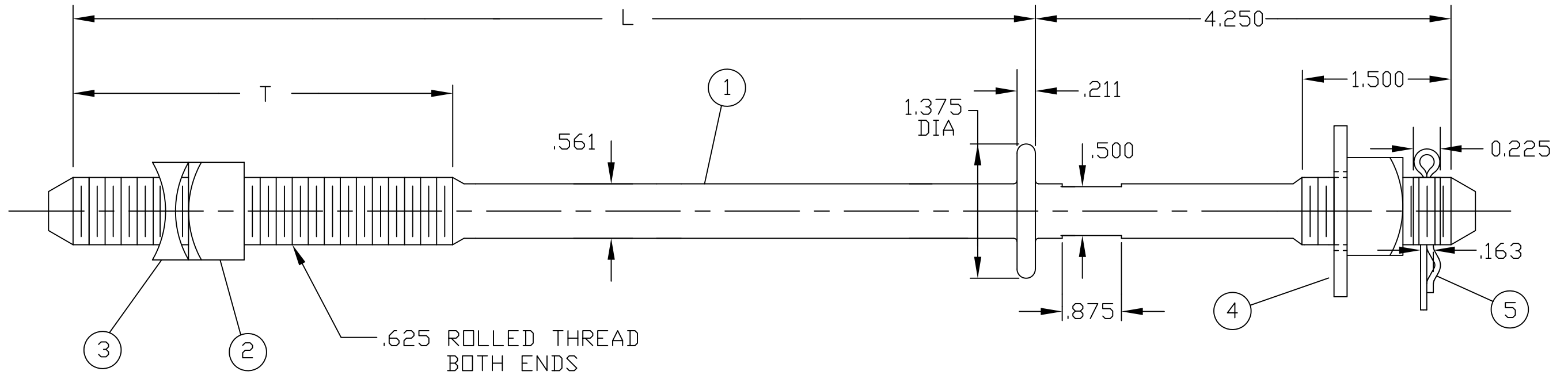

CATALOG NO.	ITEM ①	L	T
J2340-1/2	23938.10	6.000	4.000
J2341-1/2	23938.1	7.000	4.000
J2342-1/2	23938.2	8.000	4.000
J2343-1/2	23938.3	9.000	4.000
J2344-1/2	23938.4	10.000	4.000
J2346-1/2	23938.5	12.000	6.000
J2348-1/2	23938.6	14.000	6.000
J2350-1/2	23938.7	16.000	6.000
J2352-1/2	23938.8	18.000	6.000
J2354-1/2	23938.9	20.000	6.000

ITEM	PART NO.	DWG NO.	QTY	DESCRIPTION
1	SEE TABLE	23938	1	.625 DIA SINGLE UPSET SPOOL BOLT
2	J8563	23831	2	.625 REGULAR SQUARE NUT
3	J8583	23870	1	.625 SQUARE M-F LOCKNUT
4	J1088	1549-2	1	1.750 DIA ROUND WASHER
5	1100	1100	1	SELF-LOCKING COTTER PIN



.625 DIA SINGLE UPSET SPOOL BOLT ASSEMBLY

This information is confidential and is the property of Maclean Power Systems. It may not be made public or reproduced except that the Customer may make copies for use solely in instillation, maintenance, and operation of products supplied by Maclean Power Systems.

DATE: 1-8-93	SCALE: NA	NO. 1231-A	R 3	SH. 1 OF 1
DWN. BY: JB	CKD. BY:	APR. BY:		